

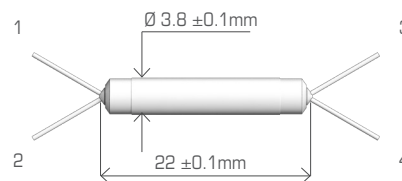

**POLARIZATION INSENSITIVE MINI 2 IN 1 ISOLATOR**

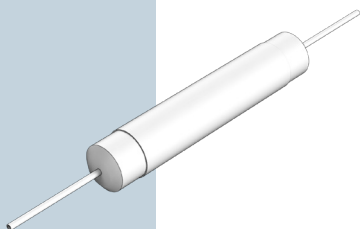

The Twin Isolator integrates two independent isolators into one standard isolator package and is excellently suited for EDFAs or instrumentation designs where two or more isolators are used. The Twin

Isolator offers excellent temperature stability, low insertion loss, high isolation, low temperature dependence and great space saving.

	PARAMETERS	DUAL STAGE		UNIT
		GRADE P	GRADE A	
<b>SPECIFICATIONS</b>	Center Wavelength ( $\lambda_c$ )	1550		nm
	Typ. Peak Isolation( Port 4 to Port 1, Port 3 to Port 2)	52	50	dB
	Min. Isolation (Port 4 to Port 1, Port 3 to Port 2), $\lambda_c \pm 15$ nm, 23°C, all polarization	40	38	dB
	Typ. Insertion Loss (Port 1 to Port 4, Port 2 to Port 3), $\lambda_c$ , 23°C, all polarization	0.6	0.75	dB
	Max. Insertion Loss, (Port 1 to Port 4, Port 2 to Port 3), $\lambda_c \pm 20$ nm, all polarization	0.9	1.0	dB
	Min. Return Loss (Input/Output)	55/55	55/55	dB
	Directivity (Port 1 to Port 2, Port 3 to Port 4), $\lambda_c$ , 23°C	55	55	dB
	Min. Crosstalk ( Port 1 to Port 3, Port 2 to Port 4), $\lambda_c$ , 23°C	50	50	dB
	Max. Polarization Dependent Loss, $\lambda_c$ , 23°C	0.1	0.2	dB
	Max. Polarization Mode Dispersion	0.07	0.1	ps
	Max. Optical Power (Continuous Wave)	300		mW
	Operating Temperature	-5 to +70		°C
Storage Temperature	-40 to +85		°C	

\*Note: \*IL is 0.5 dB higher and RL is 5 dB lower for each connector added.

CODE	STAGE	GRADE	WAVELENGTH	FIBER TYPE	CONNECTOR TYPE	FIBER LENGTH	
<b>F4M-TMISO</b>	2	Dual Stage	P Premium	55 1550 nm	25 250 $\mu$ m Bare Fiber	O None	05 0.5 m
			A A grade	S Specify	9L 900 $\mu$ m Loose Tube	A SC/UPC	10 1m
					S Specify	B SC/APC	S Specify
						C FC/UPC	
						D FC/APC	
						E LC/UPC	
						Q LC/APC	
						S Specify	

ORDER CODE EXAMPLE

**F4M-TMISO - 2 - P - 55 - 25 - 00 - 10**

